

Säulen  
Columns



Stifte  
Pins

9013.0119 / 11.12.2020



Möglichkeiten / possibilities:

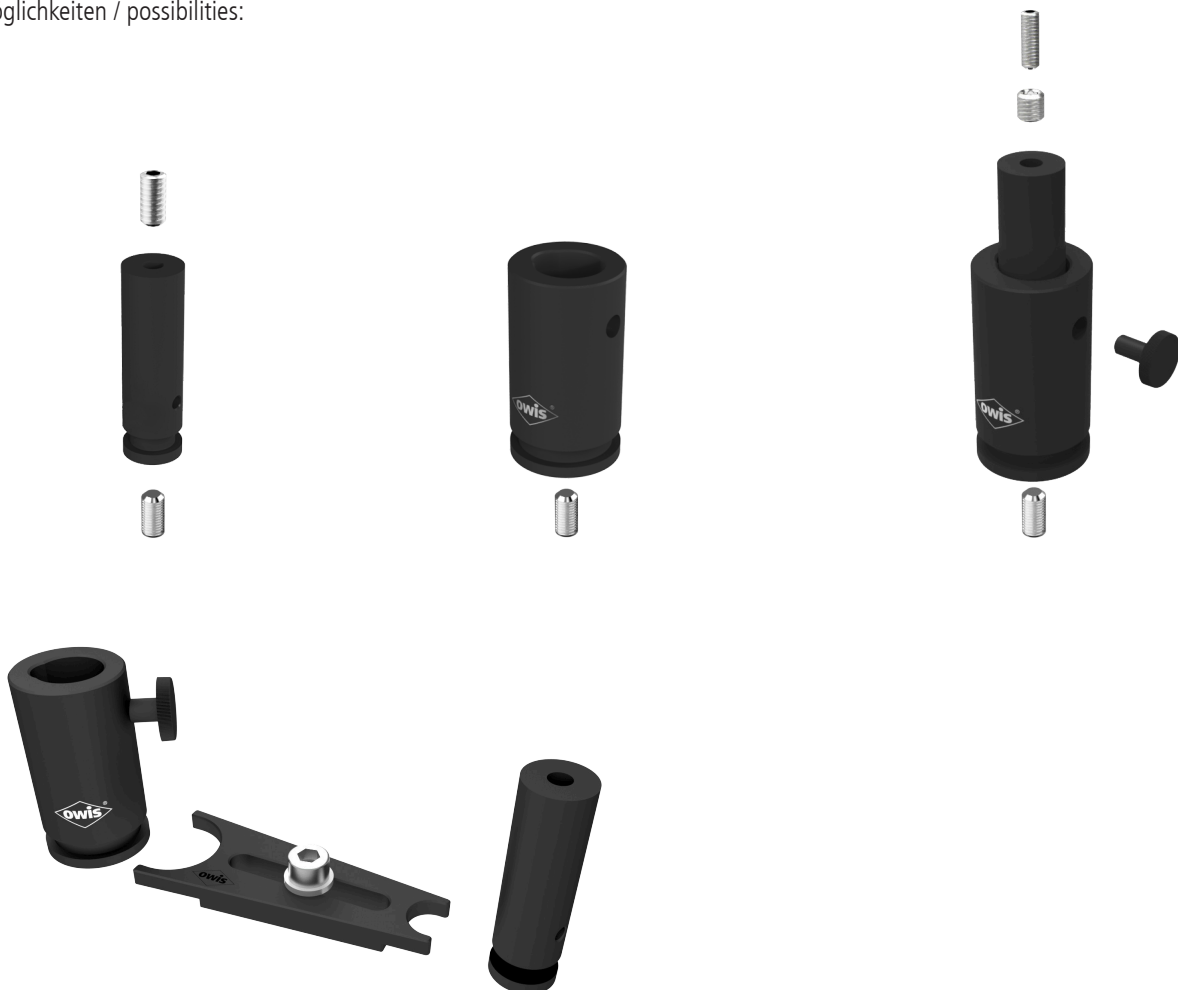

- verzugsarmes Aluminium
  - reflexionsarm, schwarz eloxiert
  - in unterschiedlichen Höhen
  - universell einsetzbar
  - 20 mm, 25 mm, 50 mm, 100 mm lang
  - Montagemöglichkeiten
    - Klemmgabel
    - in Säule SL 12/16
- deformation-resistent aluminium
  - reflection-poor, black anodized
  - in different heights
  - fit any application
  - 20 mm, 25 mm, 50 mm, 100 mm long
  - ways of installing
    - clamping fork
    - in column SL 12/16

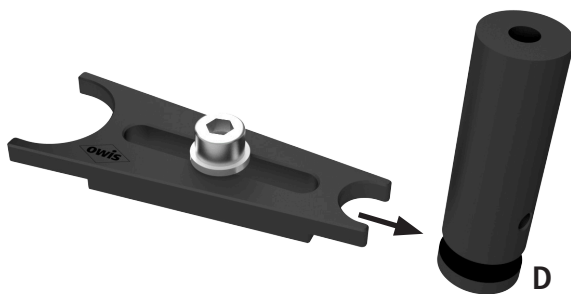
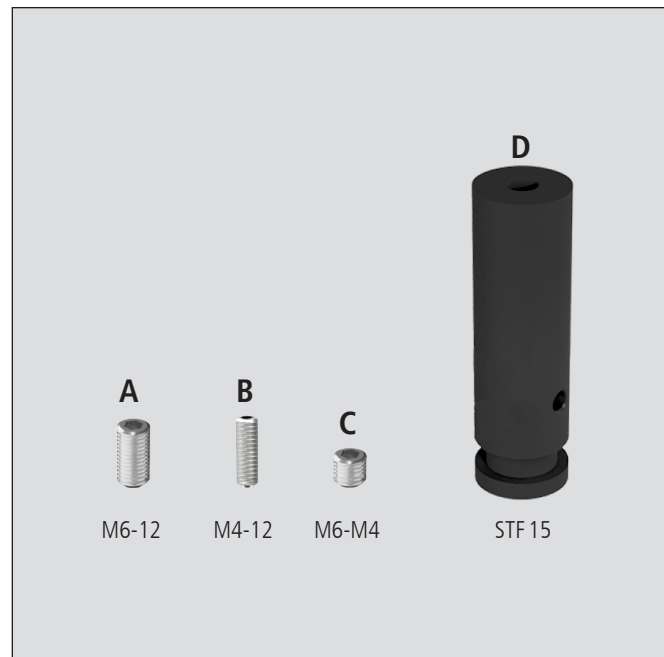

Klemmgabel / clamping fork

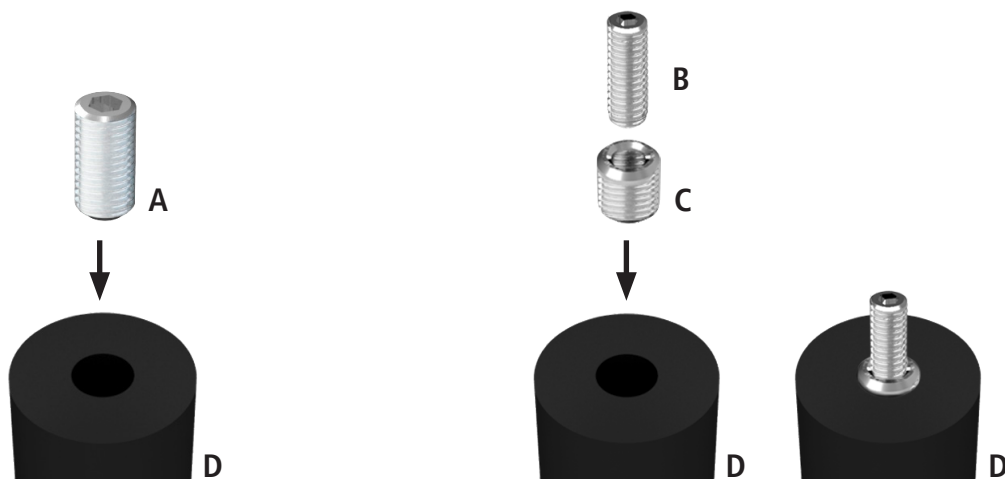

Außengewinde M6 / external thread M6

Außengewinde M4 / external thread M4

# Säulen Columns

SL 12/16

- SYS 65 bzw. SYS 90 kompatibel
- verzugsarmes Aluminium
- reflexionsarm, schwarz eloxiert
- zur Aufnahme von Stiften  $\varnothing$  12 mm bis  $\varnothing$  16 mm, z.B. Stifte STF 15
- 32,5 mm, 50 mm, 100 mm lang
- Montagemöglichkeiten
  - mit M6-Innengewinde zur Montage auf Fußplatten
  - mit M6-Außengewinde oder Klemmgabel SPG SL-STF zur direkten Montage auf optischen Tischen
- for use with SYS 65 or SYS 90
- deformation-resistant aluminium
- reflection-poor, black anodized
- for supporting pins  $\varnothing$  12 mm to  $\varnothing$  16 mm, e.g. STF 15 pins
- 32.5 mm, 50 mm, 100 mm long
- ways of installing
  - with M6 internal thread to mount onto base plates
  - with M6 external thread or clamping fork SPG SL-STF to mount directly on to optical tables

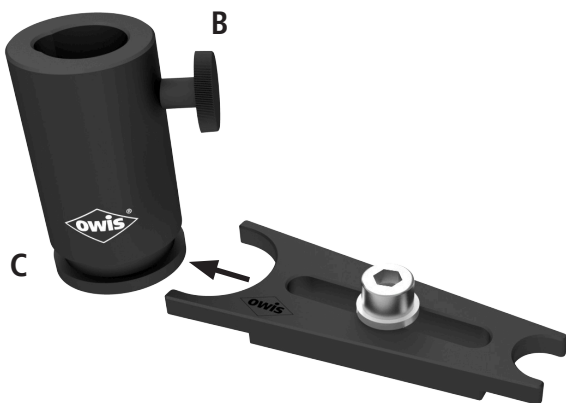
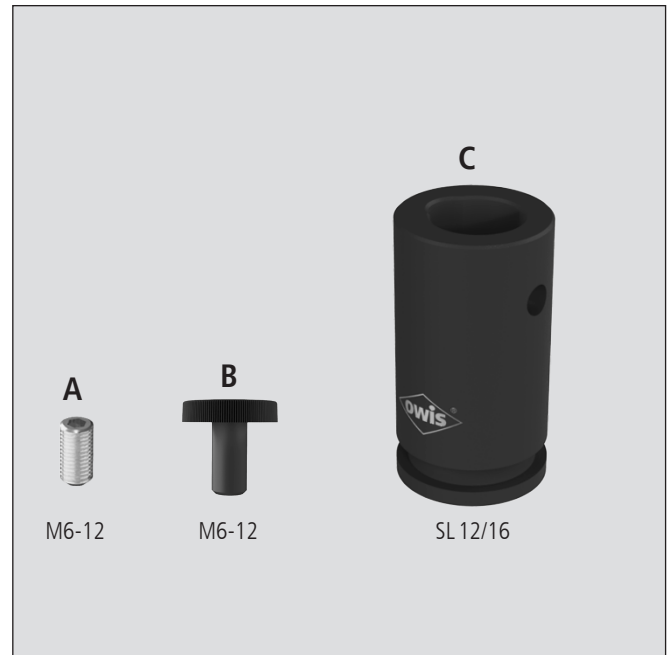

Klemmgabel / clamping fork

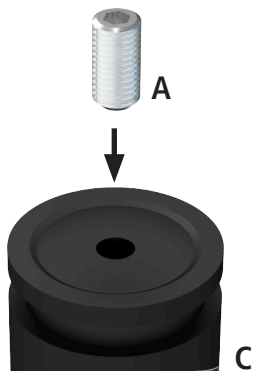

Außengewinde M6 / external thread M6

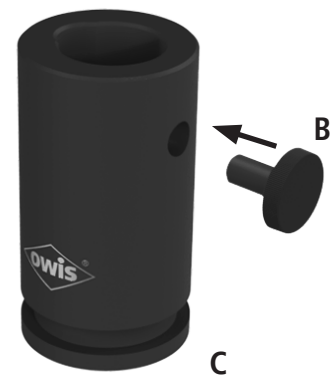

Klemmung / clamping

